

# Proposed Plat of Lands to be Assessed

(for Hearing on Objections - February 22, 2021)



Round Lake Rd

Julia Ave

Millward Ave

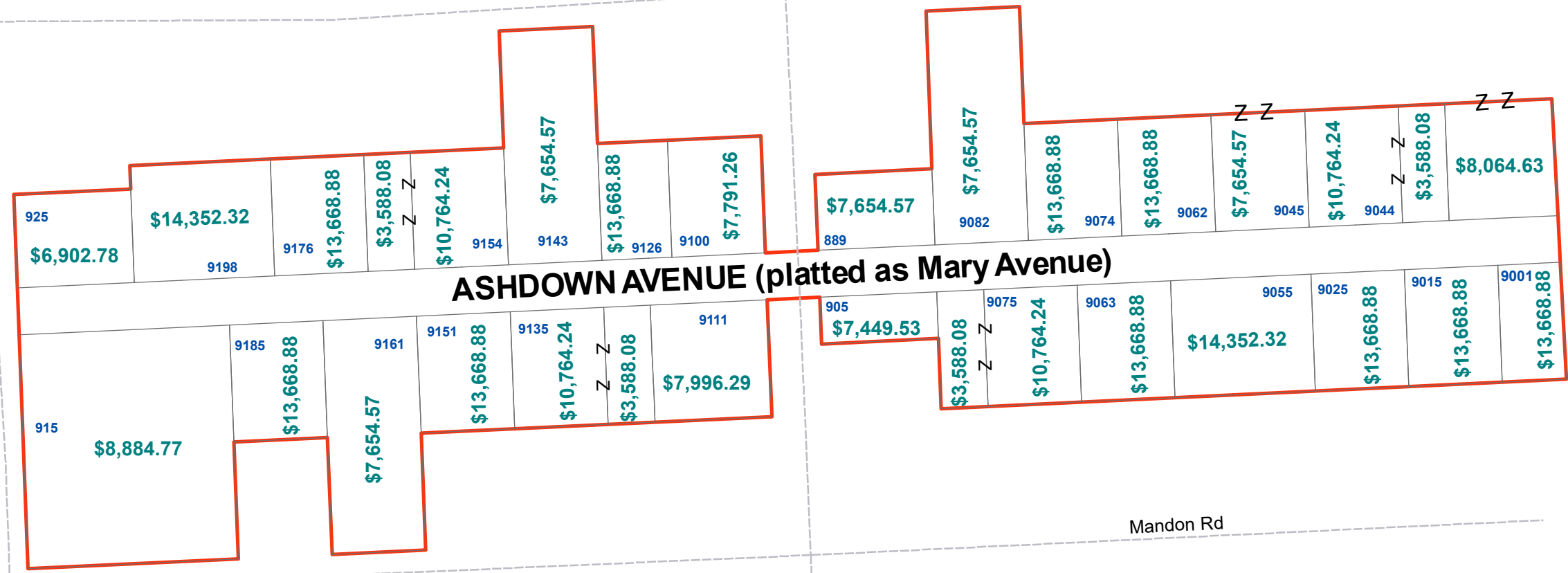

**ASHDOWN AVENUE (platted as Mary Avenue)**

**ASHDOWN  
S.A.D. No. 25054  
White Lake Township**

Ernest Blvd

**LEGEND**

Base Lot Size: 93.79 '  
Base Lot Amount: \$13,668.88 \*

\* This tentative assessment could change depending on the accepted low bid of the contractor to be hired to perform the work.

Kettering Ave

Mandon Rd

Mandon Rd