

STAGE 2 DETOUR
 SOUTH BOULEVARD BETWEEN ADAMS AND COOLIDGE

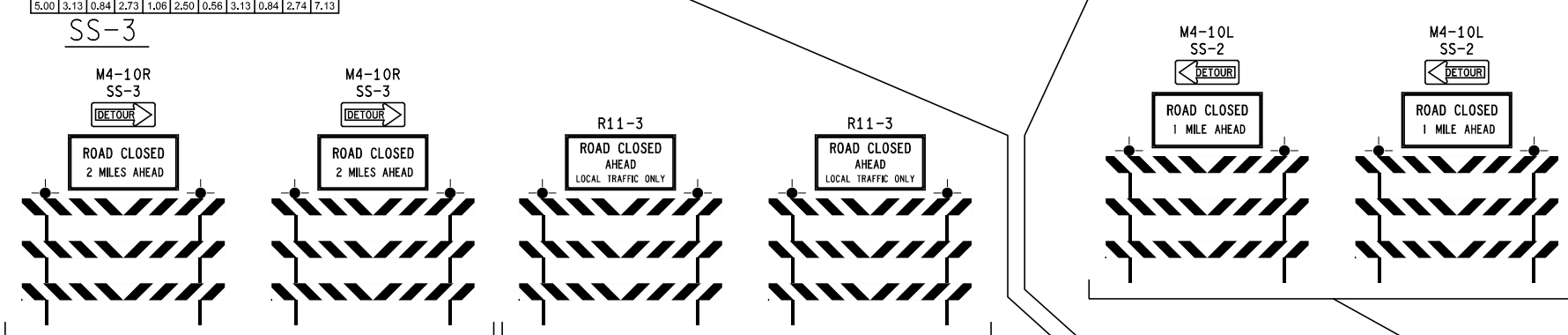
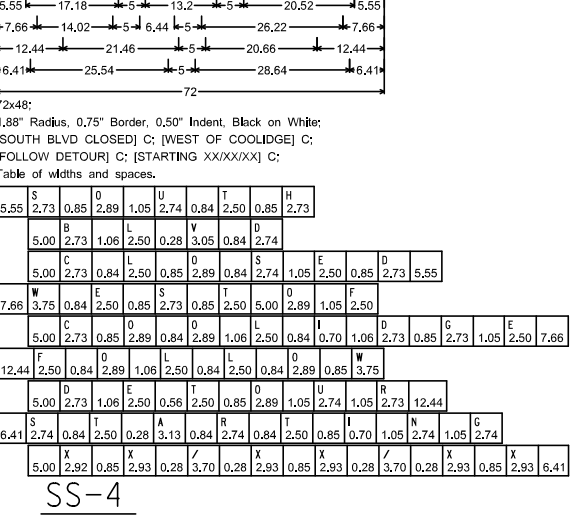
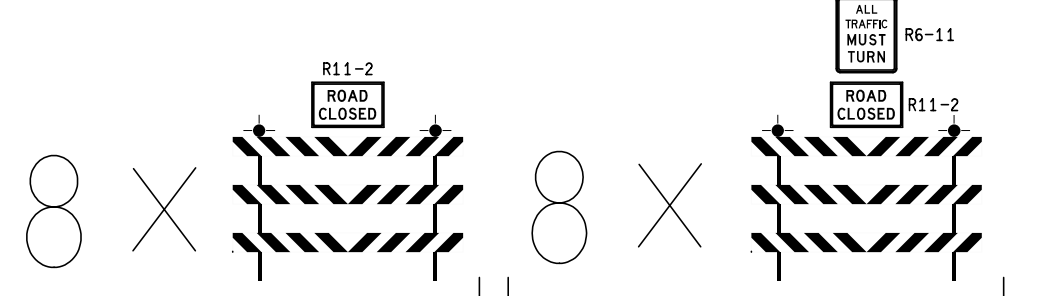
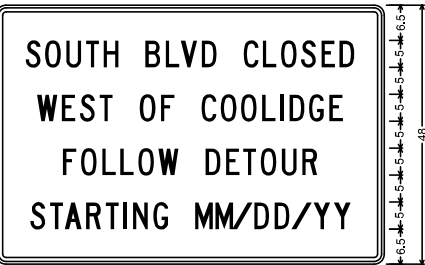

SIGN LEGEND (THIS SHEET ONLY)

SIGN	SIGN DESIGNATION	SIZE
[END DETOUR]	M4-8a	24"x18"
[DETOUR ←]	M4-9(L)	30"x24"
[DETOUR →]	M4-9(R)	30"x24"
[DETOUR ↑]	M4-9(S)	30"x24"
[← DETOUR]	M4-10L	48"x18"
[DETOUR →]	M4-10R	48"x18"
[WORK ZONE BEGINS]	R5-18c	36"x36"
[ALL TRAFFIC MUST TURN]	R6-11	24"x30"
[SIDEWALK CLOSED]	R9-9	24"x12"
[ROAD CLOSED]	R11-2	48"x30"
[ROAD CLOSED AHEAD LOCAL TRAFFIC ONLY]	R11-3	60"x30"
[ROAD WORK AHEAD]	W20-1	36"x36"
[DETOUR AHEAD]	W20-2	36"x36"
[ROAD CLOSED AHEAD]	W20-3	36"x36"
[South Blvd]	SS-1	42"x12"
[ROAD CLOSED 1 MILE AHEAD]	SS-2	60"x30"
[ROAD CLOSED 2 MILES AHEAD]	SS-3	60"x30"
[SOUTH BLVD CLOSED WEST OF COOLIDGE FOLLOW DETOUR STARTING MM/DD/YY]	SS-4	72"x48"

OHM
 ARCHITECTS ENGINEERS PLANNERS
 34000 PLYMOUTH ROAD
 LIVONIA, MI 48150
 P: 734.522.6711
 OHM-ADVISORS.COM

TROY
 MICHIGAN

ROCHESTER HILLS
 MICHIGAN

ROAD COMMISSION
 FOR OAKLAND COUNTY

CITY OF TROY, CITY OF ROCHESTER HILLS, & ROAD COMMISSION FOR OAKLAND COUNTY
 SOUTH BOULEVARD
 DETOUR SHEET - STAGE 2

DATE: _____
 DESCRIPTION: _____
 HORIZONTAL DATUM: _____
 VERTICAL DATUM: _____
 SCALE: 1" = 50'
 COUNTY: OAKLAND
 CITY/TOWNSHIP: ROCHESTER HILLS
 PROJECT NUMBER: 1100000000
 SHEET: 106 OF 167

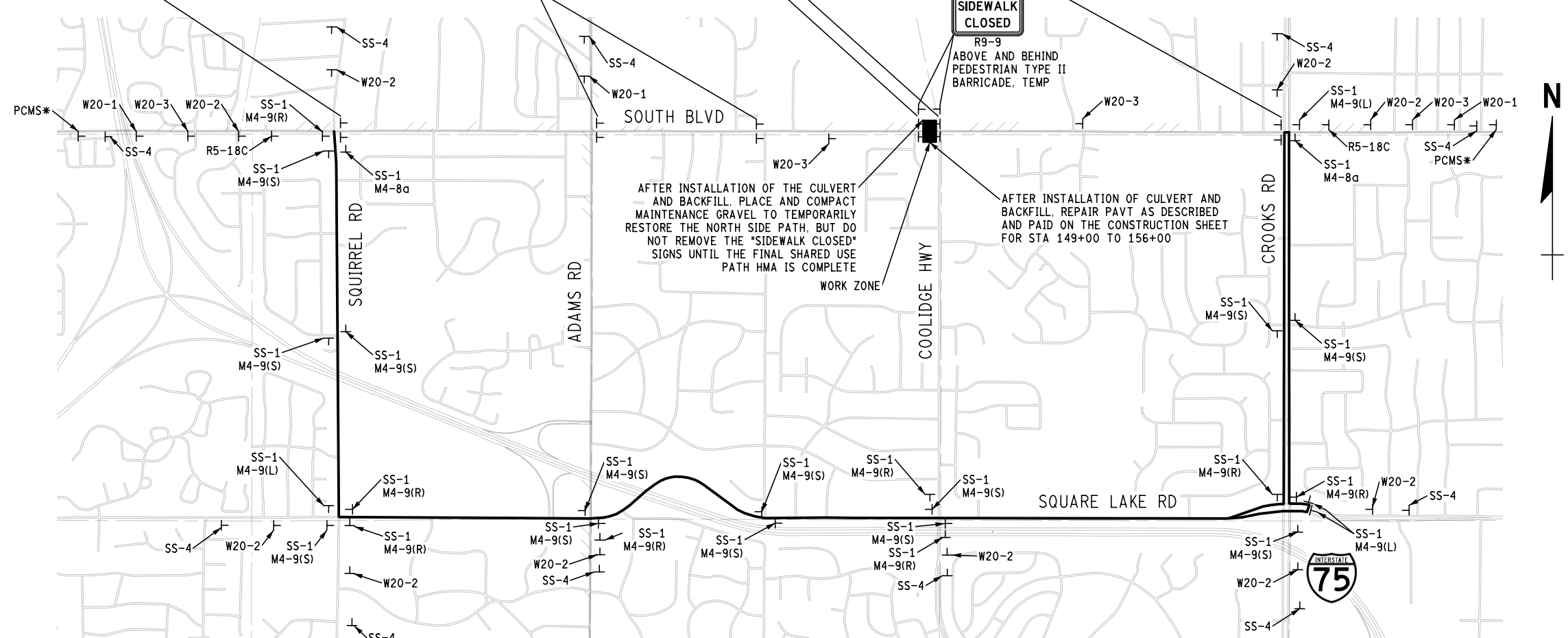

*NOTE
 PLACE PCMS 14 DAYS IN ADVANCE OF CLOSURE WITH THE FOLLOWING MESSAGE (AND NO OTHER SIGNING):

SCREEN 1	SCREEN 2	SCREEN 1	SCREEN 2
S BLVD CLOSURE MM-DD-YY	WEST OF COOLIDGE	SOUTH BLVD CLOSED	WEST OF COOLIDGE

COPYRIGHT © 2014 OHM. ALL DRAWINGS AND WRITTEN MATERIALS APPEARING HEREIN CONSTITUTE THE ORIGINAL AND UNPUBLISHED WORK OF OHM AND THE SAME MAY NOT BE REPRODUCED, DISTRIBUTED, OR DISCLOSED WITHOUT PRIOR WRITTEN CONSENT OF OHM.