

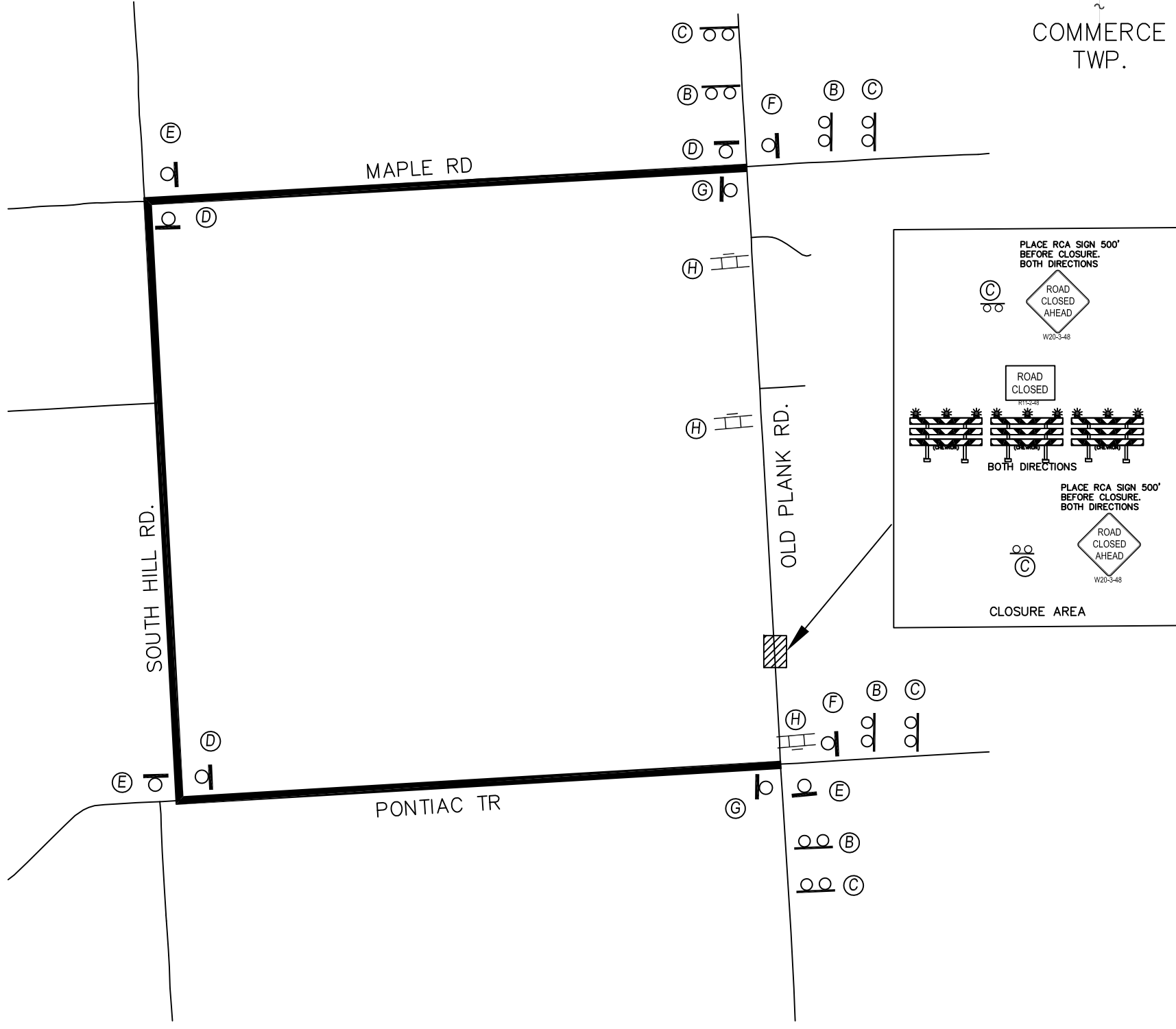

Traffic Safety Construction Detour Diagram



- ### CONTRACTOR'S RESPONSIBILITY
- AS DIRECTED BY THE ENGINEER, THE CONTRACTOR SHALL PROVIDE AND MAINTAIN ANY ADDITIONAL SIGNS, BARRICADES AND LIGHTS WITHIN THE PROJECT TO PROTECT THE TRAFFIC AND WORK AREA.
 - THE CONTRACTOR SHALL PLACE SAND BAGS ON COUNTY FURNISHED BARRICADES TO PREVENT MOVEMENT OF THE BARRICADES. HE SHALL ATTACH AND MAINTAIN THREE (3) STEADY BURN AMBER LIGHTS (TYPE "C") ON EACH OF THESE BARRICADES.
NUMBER REQUIRED (THIS SHEET) _____
 - THE CONTRACTOR SHALL BE RESPONSIBLE FOR COVERING AND UNCOVERING ALL CONSTRUCTION SIGNS AS NEEDED FOR THE PROPER MAINTENANCE OF TRAFFIC THROUGHOUT THE CONSTRUCTION AREA.
 - TRAFFIC CONTROL SIGNS AND STREET NAME SIGNS SHALL BE TEMPORARILY RELOCATED BY R.C.O.C. AND MAINTAINED BY THE CONTRACTOR. UPON COMPLETION OF THE PROJECT, TRAFFIC CONTROL SIGNS AND STREET SIGNS WILL BE RESET IN THEIR PROPER POSITION BY THE ROAD COMMISSION. THE ROAD COMMISSION MAY FURNISH AND ERECT TEMPORARY SPEED LIMIT SIGNS ALONG THE PROJECT. THE CONTRACTOR SHALL RELOCATE AND MAINTAIN THE TEMPORARY SPEED LIMIT SIGNS, AS DIRECTED BY THE PROJECT ENGINEER.
 - ANY OTHER SIGNS WHICH THE CONTRACTOR MAY BE REQUIRED TO FURNISH SHALL CONFORM TO THE MICHIGAN MANUAL OF UNIFORM TRAFFIC CONTROL DEVICES. THE CONTRACTOR SHALL NOT BEGIN ANY OPERATIONS ON THE PROJECT UNTIL ALL OF THE STOP SIGNS AND STREET NAME SIGNS HAVE BEEN RELOCATED AND FLASHER LIGHTS ARE ATTACHED TO ALL REQUIRED SIGNS AND BARRICADES.
 - ALL "TYPE III" BARRICADES FURNISHED BY THE CONTRACTOR FOR WORK PROTECTION SHALL BE COATED WITH REFLECTORIZED MATERIAL WITH STEADY BURNING LIGHTS (TYPE "C") AT SPACING OF 100 FT.(30M) MAXIMUM AS PER 1988 MICHIGAN MANUAL OF UNIFORM TRAFFIC CONTROL DEVICES.
 - THE CONTRACTOR SHALL PROVIDE AND MAINTAIN FLASHING ARROW PANELS FOR USE AS INDICATED ON ON THE PLANS OR AS DIRECTED BY THE PROJECT ENGINEER.
 - ALL TRAFFIC SIGNS WITHIN THE PROJECT WILL BE RELOCATED BY RCOC FOR EACH STAGE OF CONSTRUCTION. THE ROAD COMMISSION WILL REPAIR OR REPLACE ALL TRAFFIC SIGNS DAMAGED WITHIN THE PROJECTS LIMITS. THE CONTRACTOR WILL BE CHARGED FOR THOSE TRAFFIC SIGNS, WHICH ARE REPAIRED OR REPLACED BY THE ROAD COMMISSION, THAT WERE DAMAGED DUE TO HIS OPERATIONS.
 - TEMPORARY PAVEMENT MARKINGS SHALL BE INSTALLED BY THE CONTRACTOR. REMOVAL OF TEMPORARY MARKINGS WILL BE REQUIRED AS DIRECTED BY THE ENGINEER. THE TEMPORARY MARKING SHALL BE SIMILAR TO THE TYPE MANUFACTURED BY THE 3M COMPANY AND FLEX-O-LITE COMPANY. EXCEPT WHERE INDICATED ON THE PLANS, ALL MARKINGS SHALL BE 4 FT. (1M) IN LENGTH WITH A NOMINAL WIDTH OF 4 INCHES (100 mm), PLACED AT A MAX. SPACING OF 40 FT. (12M) CENTER TO CENTER OR AS DIRECTED BY THE PROJECT ENGINEER. THE CONTRACTOR SHALL REMOVE ANY EXISTING CONFLICTING PAVEMENT MARKING PRIOR TO INSTALLING TEMPORARY PAVEMENT MARKINGS.

- ### ROAD COMMISSION'S RESPONSIBILITY
- THE ROAD COMMISSION WILL FURNISH AND ERECT THE SIGNS LISTED BELOW AT THE LOCATIONS SHOWN ON THE CONSTRUCTION SIGNING DIAGRAM.
 - THE ROAD COMMISSION WILL PLACE BARRICADES AT EACH END OF THE PROJECT AND AT MAIN ROAD INTERSECTIONS WHEN THE ROAD IS CLOSED TO TRAFFIC.
 - WHERE A DETOUR IS NECESSARY, THE ROAD COMMISSION WILL ESTABLISH AND SIGN THE DETOUR ROUTE.
 - ALL CONSTRUCTION SIGNS SHALL BE BLACK LETTERS ON AN ORANGE BACKGROUND UNLESS OTHERWISE SPECIFIED.

MATERIALS REQUIRED

Sign/Barricade	NO. REQ'D	Notes
ROAD WORK AHEAD (A)	2	
DETOUR AHEAD (B)	4	
ROAD CLOSED AHEAD (C)	6	
DETOUR (Up Arrow)	1	
DETOUR ENDS (G)	2	
TYPE III BARRICADE ORANGE ON WHITE	9	
ROAD CLOSED TO THRU TRAFFIC (H)	3	
ROAD CLOSED (I)	2	

SPECIAL		NO. REQ'D	2	SPECIAL SIGNS	NO. REQ'D	1
---------	--	-----------	---	---------------	-----------	---

Scale: 1=1 Tech. Appr.

ROAD COMMISSION FOR OAKLAND COUNTY Beverly Hills, Michigan	DATE	PROJECT NO.	PROJECT NAME	SHEET NO.	TOTAL SHEETS
	4/20/18	N/A	COMMERCE RD CULVERT DETOUR	1	1

C:\Users\swikom\Documents\Traffic\AUTOCAD DRAWINGS\Millford\Old Plank Detour.dwg Jun 08, 2018 - 9:13am